

## Why wont my Hakko FR-810B heat -up?

In the event that your FR-810B is unable to heat-up please check the following guidelines for troubleshooting the unit.

1. An H-E error is present on the display.

When an H-E ( Heater Error) has displayed this is usually an indication that a failure has occurred within the heating element, Or it can mean the heater is not properly installed into the handle.

2. An S-E error is present on the display

When an S-E ( Sensor Error ) has displayed this is usually an indication that a failure has occurred in the sensor circuit of the heating element

Follow the steps listed below to Verify the resistance Value of your heating element as well as the sensor.

### A. Remove the heating element

**⚠ CAUTION**  
When replacing the heater, please be careful not to apply force, such as vacuum pipe is bent.

1. Remove the 4 screws that attach the heater pipe to the handpiece. Remove the heater pipe.



2. Remove the mica from inside the heater pipe.



3. Disconnect and remove the heating element assembly.



### B. Measure the resistance value

- Normal heater resistance value  
Connect an ohmmeter across the connector terminals (a).

The correct values are approximately:  $14\Omega$  ( $\pm 10\%$  100-110V),  $17\Omega$  ( $\pm 10\%$  120V),  $41\Omega$  ( $\pm 10\%$  220-240V).

If the resistance value is incorrect, replace the part.

- Normal sensor resistance value  
Connect an ohmmeter across the connector terminals (b). If the resistance value is  $\infty$ , replace the part.

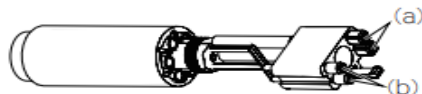

## Why wont my Hakko FR-810B heat -up?

3. If not error messages are displayed on the unit but the unit will not heat up the timer setting may need to be adjusted. The Factory default for temperature and timer settings are 600°F and ( - - - )

The timer setting on the display should read ( - - - ) for normal function if no specified time has been set into the unit, In the event that your unit displays (000) in the timer setting the unit will not heat up.

To check the current timer setting press the \* key once.

The display will first read the set temperature followed by the timer setting.

To change the Timer setting on your unit follow the steps below.

The factory default : "Temperature 600°F" "Timer --- (No setting)"

Example : When the set temperature is 300°C and the timer setting is ---.

### 1. Setting the Temperature (from 600°F to 750°F)

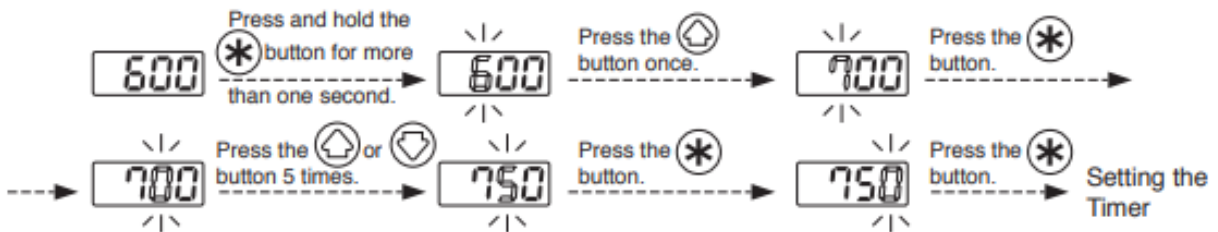

### 2. Setting the Timer (from --- to 130sec)

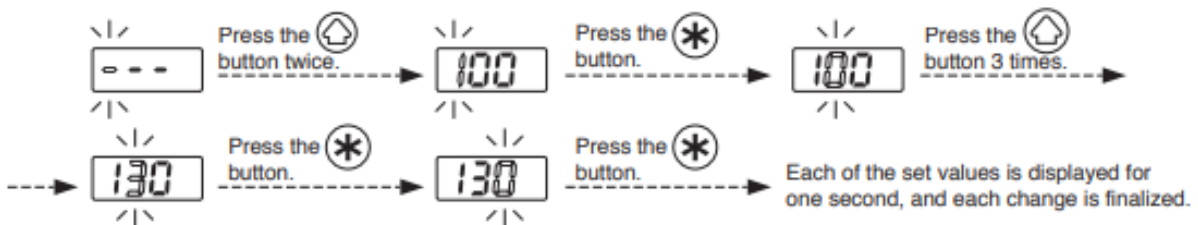

\* When you want to leave the timer "---".

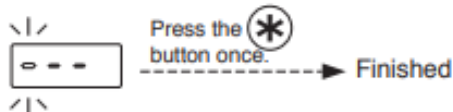

For further assistance on Troubleshooting your Hakko FR-810B hot air rework station please contact American Hakko Products.

Why wont my Hakko FR-810B heat -up?

Support@HakkoUSA.com

1-800-42-HAKKO(42556)

HakkoUSA Knowledge Base

<https://kb.hakkousa.com/Knowledgebase/11918/Why-wont-my-Hakko-FR810B-heat-u...>