

Quick Parameter Settings

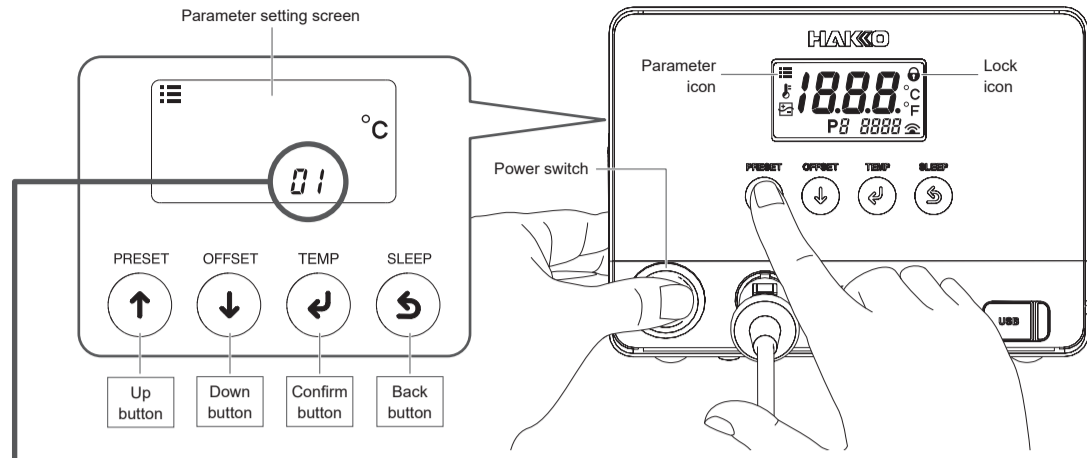

- (1) Turn on the power while pressing the [Up button].
- (2) Select the parameter number using the [Up button] or the [Down button].
- (3) Push the [Confirm button].
- (4) Change the setting using the [Up button] or the [Down button].
- (5) Push the [Confirm button].
- (6) Push the [Back button].
- (7) The normal screen reappears.

Default values are factory default settings.

Parameter No.	Parameter name/summary	Setting value	Default value Value when implementing No. 25.
01	Display temperature unit Select from °C or °F. ● All set values are converted to the changed display temperature unit.	°C/°F	 (For USA: °F)
02	Sleep: Time setting Set the time until the product transitions to sleep mode after the handpiece is placed on the iron holder. ● A shorter set time is more effective for preventing tip oxidation. ● This function is only activated if the temperature is set to 300°C (570°F) or higher. ● The normal screen reappears if you lift the handpiece from the iron holder. The normal screen also reappears if you push an operation button.	1 to 29 min	
03	Low temp alarm Set the temperature range to notify via buzzer if the tip temperature drops while soldering. ● The buzzer sound cannot be turned off.	30 to 300°C 50 to 540°F	 (°F: 540)
05	Error alarm set: [On]/[OFF] setting A buzzer sound notifies of soldering iron error [C - E] or sensor error [S - E]. Select [OFF] if you do not wish to use this function.	On/OFF	
06	Ready alarm: [On]/[OFF] setting A buzzer sound notifies that the tip has reached the setting temperature. Select [OFF] if you do not wish to use this function.	On/OFF	
07	Sleep: [On]/[OFF] setting Set whether or not to automatically transition to sleep mode once the time set in parameter No. 02 is reached.	On/OFF	
08	Auto shut-off: [On]/[OFF] setting Set whether or not to automatically turn the product off once the time set in parameter No. 18 is reached.	On/OFF	
12	Output mode: Power [P]/normal [n] setting Power [P] is useful for workpieces that require a large amount of heat. Normal [n] is useful for temperature-sensitive workpieces.	P/n	
13	Sleep: Activation temperature setting Set the tip temperature during sleep configured in parameter No. 02. ● A lower setting temperature is more effective for preventing tip oxidation. ● The normal screen also reappears if you push any operation button.	200 to 300°C 390 to 580°F	 (°F: 400)
14	Password lock: [On]/[OFF] setting Limit the scope of change using a combination of six characters <i>AbCdEf</i> and three digits. • Select [OFF]..... None are locked • Select [On]..... Locks all • Select [PAR] > [03]..... Locks changes to offset temperature • Select [PAR] > [P]..... Locks preset temperature selection • Select [PAR] > [5]..... Locks temperature changes via the [TEMP] button	OFF On* PAR*	Process when [PAR] is selected When [PAR] is selected From (a) to (c), use to select On/OFF. Enter the password and push .
18	Auto shut-off: Time setting Set the time until the product transitions to powered down mode after the handpiece is placed on the iron holder. If a time of 30 minutes is set, the buzzer sounds three times every 30 minutes. ● The normal screen also reappears if you push any operation button. ● A shorter set time is more effective for preventing tip oxidation.	30 to 60 min	
23	Preset temperature: Changing registered temperatures You can register up to five frequently used setting temperatures. This function saves time when changing the setting temperature. Default value: P1 250°C (600°F), P2 300°C (700°F), P3 350°C (750°F), P4 400°C (800°F), P5 450°C (850°F)	50 to 500°C 120 to 940°F (Same as the station's temperature range)	 With , the display switches between P1 > P2 > P3 > P4 > P5. Change the P2 temperature. Temperature changed
24	Preset temperature: [On]/[OFF] setting Set whether or not to use the preset temperature function for each temperature. Default value: On/P3 350°C ● The [PRESET] button is disabled if you set all five options to [OFF]. ● If you change P3 to [OFF] and push the [PRESET] button in the normal screen, the display switches between P1 > P2 > P4 > P5.	On/OFF	 P1 has been disabled.
25	Initial reset Reset the product to factory default settings.	°C/°F	 When °C is selected

Note

- If the power is turned off while configuring settings, the changes may be lost.
- If you set the password in No. 14, the lock icon appears on the normal screen and a password prompt appears before transitioning to the parameter setting screen. Contact us if you do not know the password.

E-mail: support@hakko.com

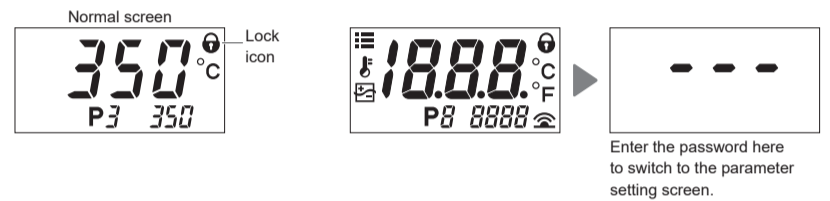

This function is convenient for when you want to work within a specified temperature range.

To solder between 320 and 350°C at a setting temperature of 350°C, change the setting value to [30] in No. 03 before beginning soldering. The buzzer will sound, notifying you when the tip sensor temperature is lower than 320°C while soldering. The upper limit is restricted by the setting temperature.

Leave the No. 07 default value set to [On], and set No. 02 & 13 to desired settings.

In sleep and auto shut-off, tip oxidation is prevented, which can extend the tip lifetime.

Set No. 08 to [On], and set No. 18 to desired settings.

Connecting to a Computer

1. Setting parameters on a computer

With the included USB cable and software, you can change parameter settings on a computer and duplicate them to another station. You can also save the soldering work/offset value (temperature correction) changes history.

NOTE Do not use USB cable that is more than two meters long.

NOTE Only Windows 10 is supported.

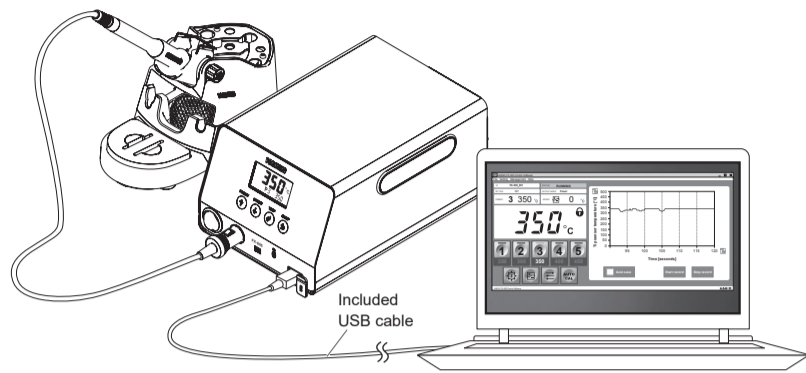

2. Installing the software

(1) Double-click the software (HAKKOControlSoftwareSetup X.X.X.X.exe) from the CD-ROM or downloaded from Online.

(2) Select a language, and then click [OK].

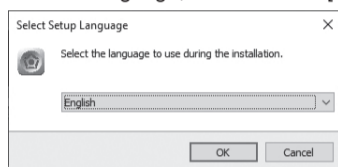

(3) Check the License Agreement, select [I accept the agreement], and then click [Next].

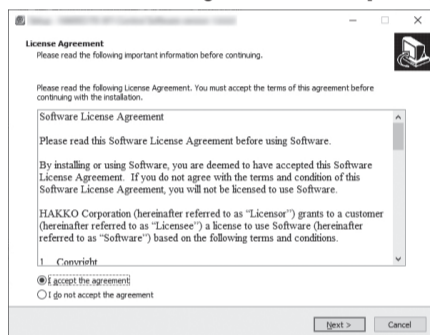

(4) Follow the on-screen instructions to complete the installation.

(5) If the software is installed correctly, it will be launched automatically.



Downloading the Software (Online)

(1) Go to the HAKKO website and visit [Customer support\Support & service>Login/Signup].



https://www.hakko.com/doc_support-e

(2) Follow the on-screen instructions to complete user registration.

Once user registration is complete, you can use My Page.

(3) Click [My page (Product registration from here)] to register the product.

NOTE You can only download the software after registering the product.

(4) Click [Download of product data] from the menu at the top right of the page.

(5) Select [SOFTWARE] in the document search area.

(6) Enter the product name as a keyword.

(7) Select a language, and then click [Search by Condition].

(8) Click [Download] in the search results.



HAKKO CORPORATION

HEAD OFFICE

4-5, Shiokusa 2-chome, Naniwa-ku, Osaka 556-0024 JAPAN
TEL: +81-6-6561-3225 FAX: +81-6-6561-8466
<https://www.hakko.com> E-mail: sales@hakko.com

OVERSEAS AFFILIATES

U.S.A.: AMERICAN HAKKO PRODUCTS, INC.

TEL: (661) 294-0090 FAX: (661) 294-0096

Toll Free (800) 88-HAKKO

<https://www.HakkoUSA.com> E-mail: Support@HakkoUSA.com

HONG KONG: HAKKO DEVELOPMENT CO., LTD.

TEL: 2811-5588 FAX: 2590-0217

<https://www.hakko.com.cn> E-mail: info@hakko.com.hk

SINGAPORE: HAKKO PRODUCTS PTE., LTD.

TEL: 6748-2277 FAX: 6744-0033

<https://www.hakko.com.sg> E-mail: sales@hakko.com.sg

Please access the code for overseas distributors.
https://www.hakko.com/doc_network



© 2022 HAKKO Corporation. All Rights Reserved.
Company and product names are trademarks or registered trademarks of their respective companies.